

# Cabinet Solutions

## Swing Frame Cabinet

### 19" Swing Frame Wall Mount

Global **SIX**



#### Features

- Double section, compatible with 19" standard equipments
- Tempered glass/Perspex front door with 180° turning capacity
- Removable side panels, easy to install and maintain (lock optional)
- Cable entry on the top and bottom with knock-out plates
- L-shaped mounting profile, easy to adjust on the mounting rail
- Fan cutout on the top, for two fans (Fans optional, new improved low noise 40db)
- Swing back with 90° turning Capability
- Latch clip on the side for extra support
- Guiding pin for extra support
- Welded triangle support brackets
- Venting on top and side
- RU Marketings printed on both front & rear mounting rails
- Colour: Black (Available in different colours on Request)

#### Specification

<b>Standard:</b>	Comply with ANSI/EIA RS-310-D, IEC297-2, DIN1497, PART1, DIN41494, PART7, GB/T3047.2-92
<b>Material:</b>	SPCC quality cold rolled steel Thickness: Mounting profile: 2mm other: 1.2mm
<b>Loading Capacity:</b>	6U-22KG AND 9U/12U/15U-30KG
<b>Rating:</b>	IP20
<b>Surface Finish:</b>	Degreasing, pickling, Phosphating, Powder
<b>Packaging:</b>	Flat Packed or Assembled

#### Size

<b>Width:</b>	19" 600mm
<b>Heights:</b>	6U, 9U, 12U & 15U
<b>Depths:</b>	600mm (500mm Wall box & 100mm Collar) 800mm (600mm Wall box & 200mm Collar)

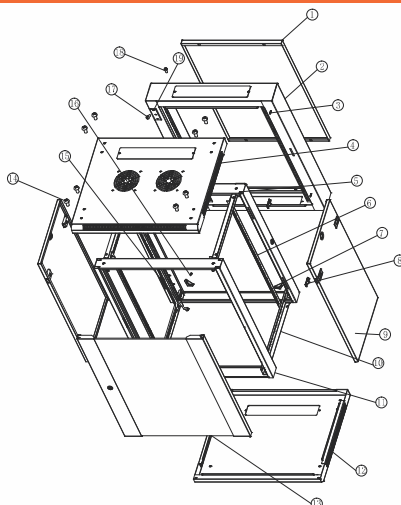

1. Back Plate
2. Back Door
3. Guiding Pin
4. Top Cover
5. Rear Frame
6. Mounting Profile
7. Triangles Support Bracket
8. Latch
9. Side Panel
10. Mounting Angle
11. Front Frame
12. Bottom Cover
13. Front Glass Door
14. M8\*12 & M8 Nut
15. M6\*12
16. M5\*8
17. M5\*20 & M5 Nylock Nut
18. M4\*8
19. External Hinges

#### Part Numbers

<b>WCC06-660-BNV</b>	6U Swing Frame Cabinet 600mm Deep Black
<b>WCC09-660-BNV</b>	9U Swing Frame Cabinet 600mm Deep Black
<b>WCC12-660-BNV</b>	12U Swing Frame Cabinet 600mm Deep Black
<b>WCC15-660-BNV</b>	15U Swing Frame Cabinet 600mm Deep Black
<b>WCC15-680-BNV</b>	15U Swing Frame Cabinet 800mm Deep Black